

The Railroad Battery Watering Gun is designed to be used with a variety of water sources. It can be connected to a building's water main, our HydroFill Watering Cart or HydroPure Deionizer. **If the static water pressure is greater than 75 PSI (5.2 bar), a pressure reducer must be installed. Part number PS-PR.**

Installation

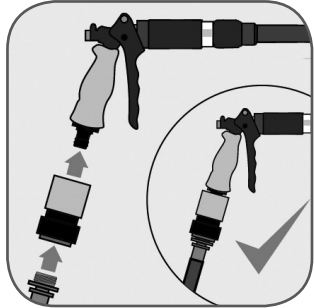

Attach the quick-connect fitting and the gun to your 1/2" (12.5 mm) water hose.



Turn on the water supply, watering cart or Deionizer.



Squeeze the trigger to clear the hose of any air.



Continue until all air in the hose has been cleared and the water flow is uniform.

Operation



Turn on the water supply.

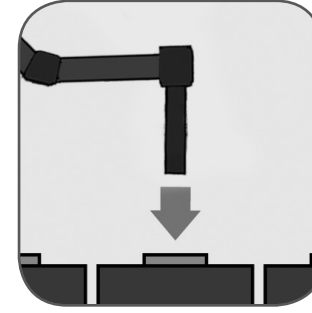

Insert the nozzle into the battery cell to be filled.



Squeeze the trigger until shut-off takes place.

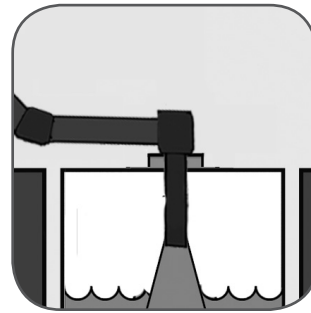

The spinner will continue to spin indicating that water is flowing.

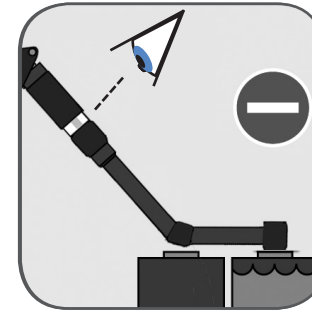

When the spinner has stopped, the flow has stopped; release the trigger.



Lift the tip of the gun out of the cell.



Gently tap the nozzle to remove any drips*.

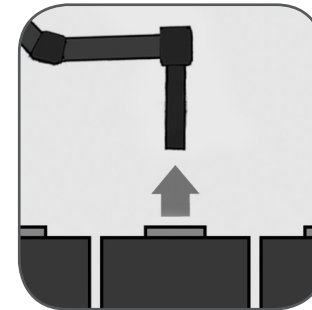

Remove the gun from the battery.



Ensure the water supply is switched off after use.

*Please note that after use the gun may drip a little water. This is expected and necessary for the automatic resetting feature.



HEALTH AND SAFETY PRECAUTIONS

Batteries contain sulphuric acid, always wear approved protective clothing (gloves, goggles and apron).





Railroad Battery Watering Gun Model: GUN-RR Installation & Operating Instructions

Philadelphia Scientific LLC
207 Progress Drive,
Montgomeryville, PA 18936 USA
P: 215.616.0390 F: 215.616.0500

© 2010 Philadelphia Scientific LLC. All Rights Reserved. Philadelphia Scientific and the PS logo are registered trademarks of Philadelphia Scientific LLC. HydroFill a trademark of Philadelphia Scientific LLC. E&O.E.

PAKA545
04/25/12