

## Blinky™

Philadelphia Scientific offers a complete selection of battery water level monitors: The *Blinky* Range, so you can be reassured you have chosen the optimal solution for your application and budget.

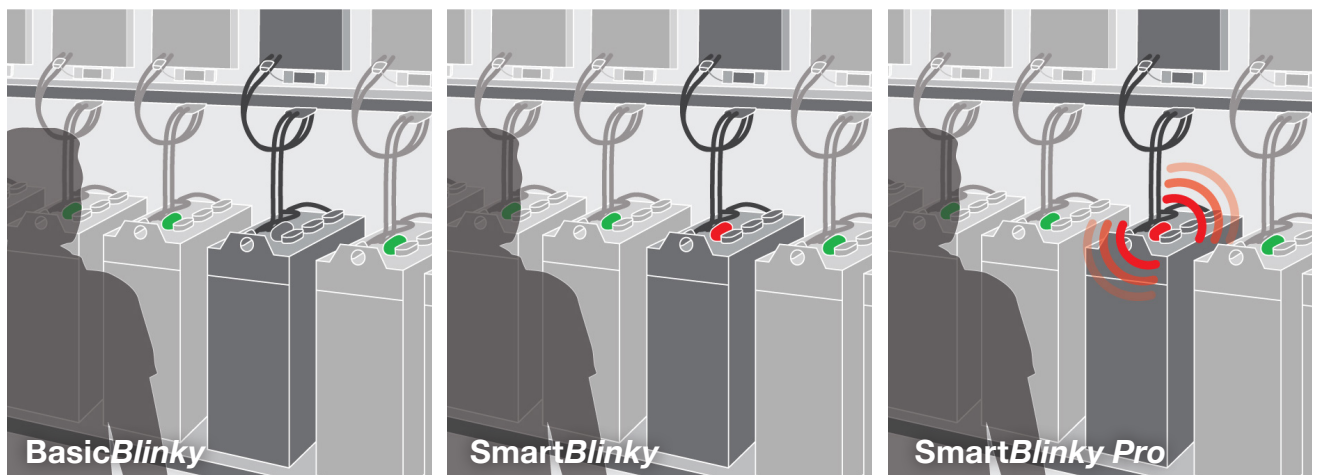

### Let your batteries tell you when they need water.

The *Blinky*™ range of battery water level monitors (BWM) features patented UL Classified® technology that dramatically improves battery maintenance by intelligently alerting personnel when a battery needs water.

The new super bright LED light indicator and audible alarm (Pro unit) eliminate operator error by clearly indicating when a battery has sufficient electrolyte.

Philadelphia Scientific has three tiers of battery water level monitors to suit all applications and budgets:

- *BasicBlinky* is the entry level battery water level monitor. It has provided decades of protection against battery dry out and remains the industry leading low-cost battery monitor.
- *SmartBlinky* is our mid-range battery water level monitor and offers comprehensive functionality for great value. The unique SmartDelay feature provides 100% confidence of a true indication.
- *SmartBlinky Pro* adds an audible alarm and fool proof installation to SmartDelay, making *SmartBlinky Pro* the gold standard for battery monitors.

### Features

- ✓ New super bright LED lights make our *Blinkys* much more visible.
- ✓ Stronger LED housing and low profiles on the battery reduce the chance of breakage during service.
- ✓ Wide operating voltages and 'forgiveness' zones make *Blinkys* suitable for Monobloc batteries and ensure breakage through incorrect installation is minimised.

## Features and benefits summary

	Basic <i>Blinky</i>	Smart <i>Blinky</i>	Smart <i>Blinky</i> Pro
<b>Indication</b>	OK: Green Fill now: No light	OK: Green with pulse Fill soon: Solid green/red with red flash Fill now: Red asymmetric warning flash Refilled: Green flash	OK: Green heartbeat Fill soon: Green/red heartbeat Fill now: Red asymmetric warning flash Refilled: Green flash
<b>LED</b>	Super bright LED	Super bright LED	Matrix of four super bright LEDs
<b>Audible alarm</b>	No	No	Yes
<b>SmartDelay</b>	No	Yes	Yes
<b>Days without water indicator</b>	No	No	Yes
<b>Operating voltage</b>	4.0v	4.0v to 12.0v	Universal
<b>Forgiveness zone</b>	7.0v to 18.0v hibernates	14v to 16.0v hibernates	N/A
<b>Nominal current</b>	28.0mA	2.67mA	@ 24V 20mA, @ 48V 10mA, @ 80V 5mA
<b>Anycell installation</b>	No	No	Yes
<b>Reverse polarity protection</b>	Yes	Yes	Yes
<b>Versions</b>	Standard - LED on the probe	Standard: LED on the probe Remote: LED located anywhere on battery Cyclops: LED mounts between the cables Detachable: Allows the LED to be mounted anywhere. Interface: A 'clean contact' output for connection to 3rd party devices	Standard: LED on the battery Remote: LED mounted between the cables
<b>Connections</b>	(B) M10 steel ring (S) M4 steel ring & screw (Q) FlexiTap piercing	(B) M10 steel ring (S) M4 steel ring & screw (Q) FlexiTap piercing	(S) M4 steel ring & screw (Q) FlexiTap piercing
<b>Fuses</b>	B & S - 1, Q - 2	B & S - 2, Q - 3	B & S - 2, Q - 3
<b>Flame retardant</b>	UL V-0	UL V-0	UL V-0
<b>Certification</b>	UL, C-Tick, CE Mark	UL, C-Tick, CE Mark	UL, C-Tick, CE Mark
<b>6v and 12v Monobloc</b>	Yes	Yes	Yes
<b>Weight</b>	90.7 grams	90.7 grams	120 grams
<b>Housing dimensions</b>	L = 27 mm W = 12 mm H = 15 mm	L = 33 mm W = 12 mm H = 14 mm	L = 62 mm W = 32 mm H = 25 mm
<b>Warranty</b>	1 year	1 year	1 year
<b>Generation</b>	Third	Third	First
<b>ROI week</b>	9	18	20



[www.phlsci.com](http://www.phlsci.com)

**Philadelphia Scientific Americas**  
207 Progress Drive, Montgomeryville, PA, 18936 USA  
P: +1 (0) 215 616 0390 F: +1 (0) 215 616 0500

**Philadelphia Scientific EMEA**  
188 Oxford Grove, Bolton, BL1 3BH, UK  
P: +44 (0) 1204 467777 F: +44 (0) 1204 493300

**Philadelphia Scientific Asia Pacific**  
2/17 Norman Street, Peakhurst, NSW, 2210, Australia  
P: +61 (0) 2 8004 2447 F: +61 (0) 2 9012 0383