

# INSTRUCTIONS

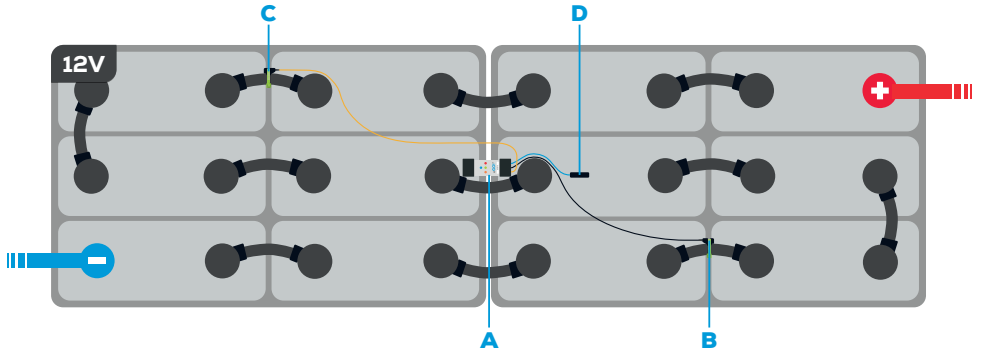

## EGO3-12QE/SE/QEF/SEF



EGO3-S



EGO3-Q



### TOOLS REQUIRED

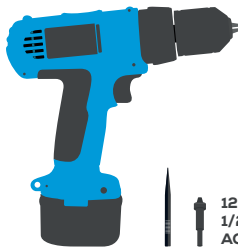

12MM  
1/2"  
ACC-041



ACC-044



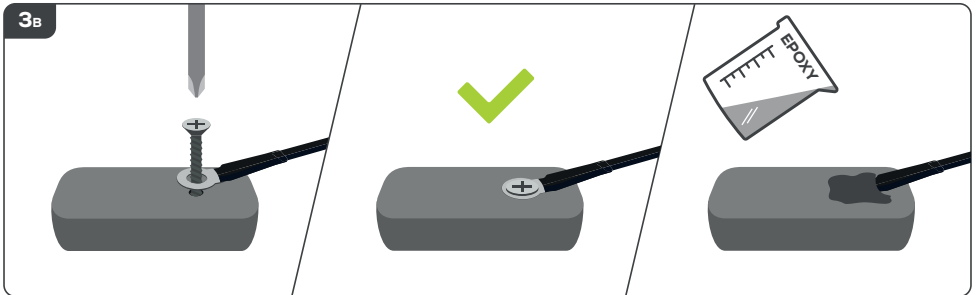
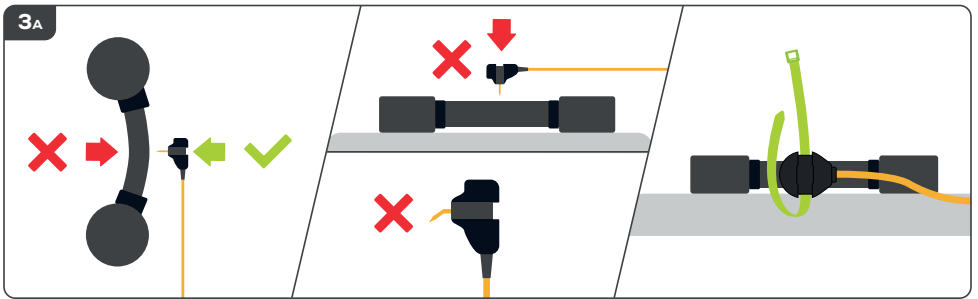
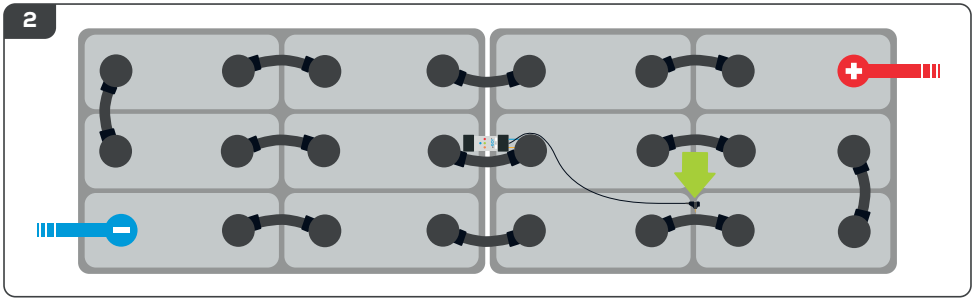
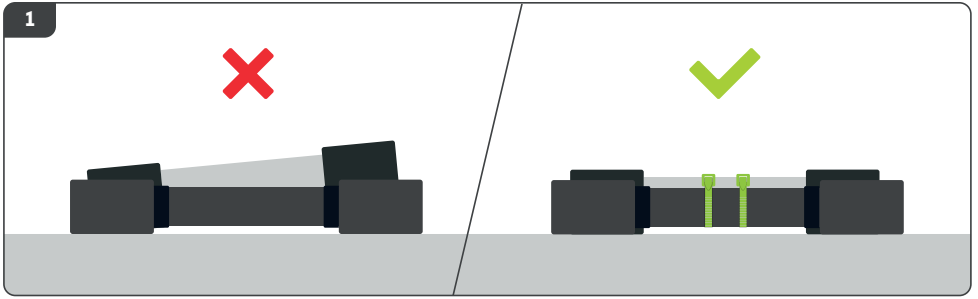

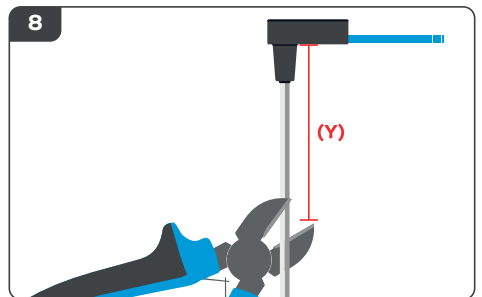
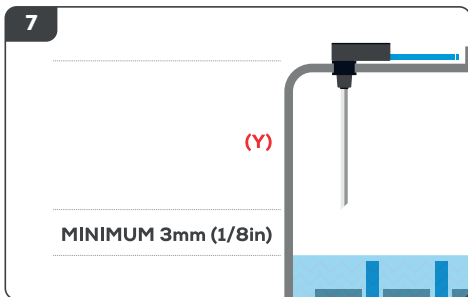
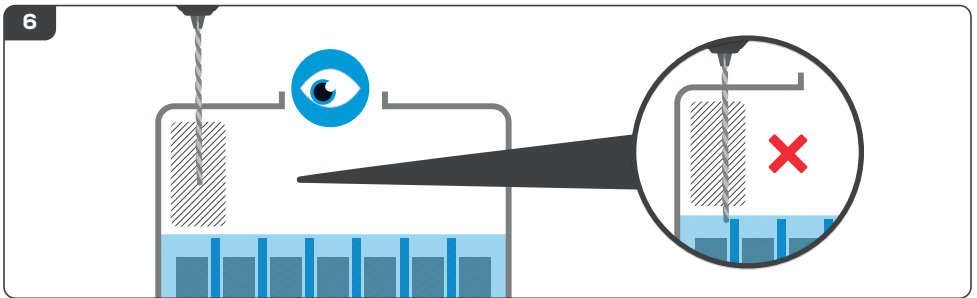
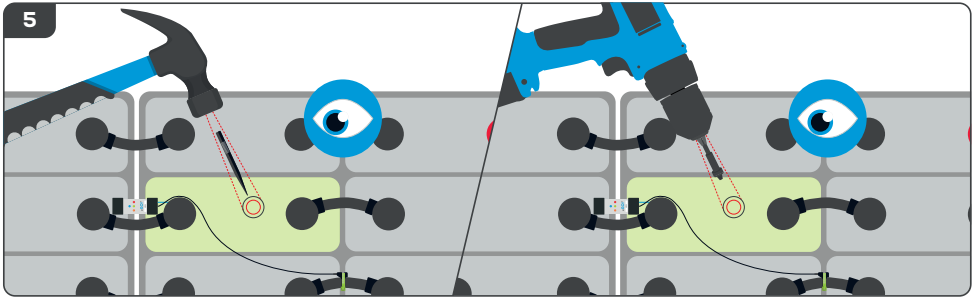
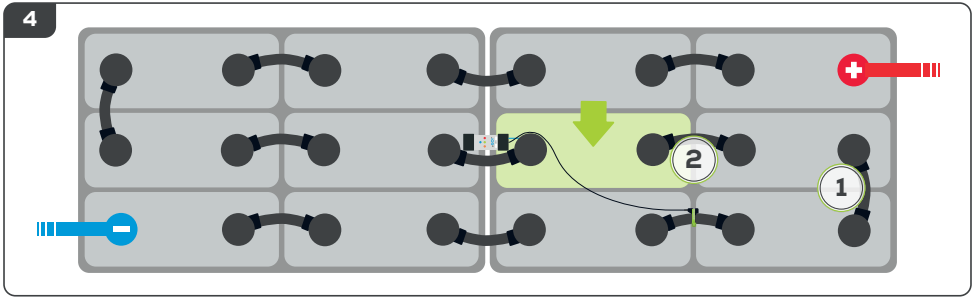

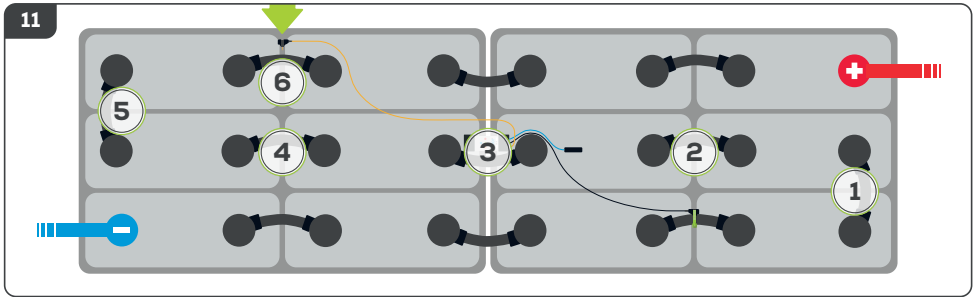
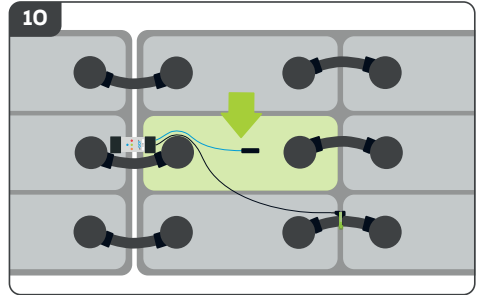
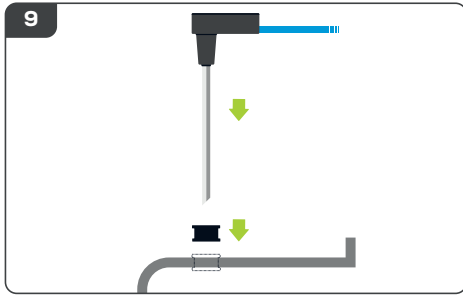

## INITIAL START UP



ONCE THE POWER CONNECTIONS HAVE BEEN MADE AND THE ELECTROLYTE LEVEL INDICATOR HAS BEEN CORRECTLY INSTALLED, THE EGOi3 IS READY TO START MONITORING. YOU SHOULD EXPECT TO SEE THE FOLLOWING LIGHT SEQUENCE ON THE EGOi3:



LIGHTS IN SEQUENCE.



RED (PLUS WHITE PULSE IF ACCESSORY FITTED)

1 PULSE FOR SOLENOID OPTION.  
2 PULSES FOR PUMP OPTION.  
3 PULSES FOR DASH INDICATOR.



WIRELESS COMMUNICATIONS INITIALIZING.



WARNING: CHECK INSTALLATION. THIS LIGHT INDICATION MEANS THAT THE EGOi3 DETECTS A VOLTAGE OUTSIDE OPERATING VOLTAGE. CHECK THE INSTALLATION IS ACROSS 12V (6 CELLS) AND THAT THE BATTERY IS NOT ON CHARGE.



BLUE SHOULD BE FLASHING WITH AN ALTERNATE GREEN AND RED FLASH. THIS INDICATES THAT THE EGOi3 IS LISTENING FOR ANY UPLOAD INFORMATION. THIS LASTS FOR 2 MINTUES AFTER WHICH NORMAL LIGHT INDICATION WILL RESUME.

## LED INDICATIONS

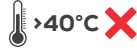
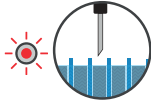
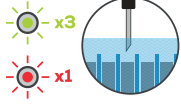
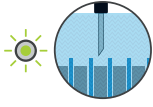

**FOR AN INSTALLATION VIDEO SHOWING A STEP BY STEP GUIDE TO CORRECTLY INSTALL YOUR eGO!<sup>3</sup> BATTERY LIFE MONITOR PLEASE VISIT:**



**[BIT.LY/EGO3FINSTALL](https://bit.ly/ego3finstall)**

**FOR ADVANCED FEATURES, USER GUIDES AND FURTHER INFORMATION PLEASE VISIT:**



**BIT.LY/EGO3BLM**

DOC0157 © 2018 Philadelphia Scientific UK Ltd. All Rights Reserved. Philadelphia Scientific and the PS logo are registered trademarks of Philadelphia Scientific. eGO3 is a trademark of Philadelphia Scientific LLC. ESO.E



**WWW.PHLSCI.COM**

Philadelphia Scientific LLC  
P: +1 (215) 616 0390  
E: [info@phlsci.com](mailto:info@phlsci.com)

Philadelphia Scientific EMEA  
P: +44 (0) 1204 467777  
E: [info@ps-europe.net](mailto:info@ps-europe.net)



Philadelphia Scientific ASIA PACIFIC  
P: +61 (2) 8004 2447  
E: [info@phlsci.com.au](mailto:info@phlsci.com.au)