

Dual HydroPure Deionizer Cart Installation & Operating Instructions

Model: CRT-143

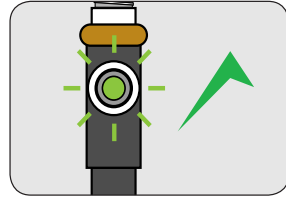

Light Indicator

Green flashing light = Ready to dispense battery water.

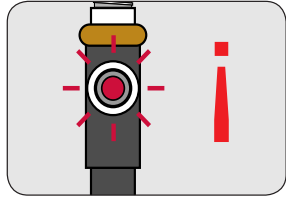

Red flashing light = Replace cartridge.

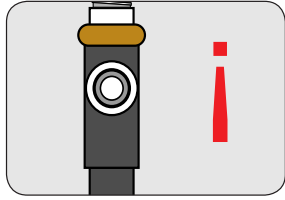

No light = Power problem.
Check and/or replace batteries.

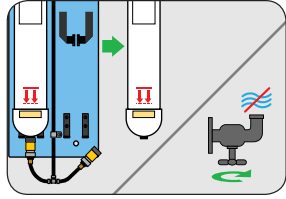

Ensure water supply is turned off and remove old cartridge.

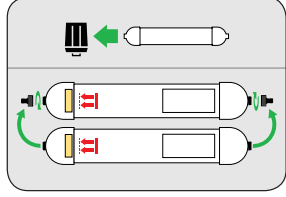

Transfer the 2 male quick-connect fittings to the new cartridge then safely dispose of the old cartridge.

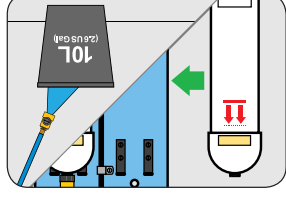

Fit new cartridge and run off 10L (2.6USGal) of water before use.

*Please note that when the batteries are removed or changed a light function test is performed. The sequence of illumination is: (a) Red light single pulse, (b) Green light single pulse, (c) Red and Green lights together single pulse, (d) Return to normal flashing mode.

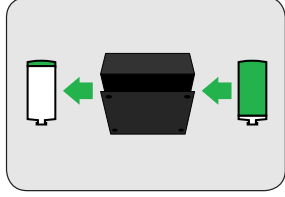

Remove the cover and replace the battery*.

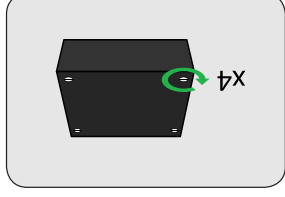

Replace the 4 screws in the battery casing.

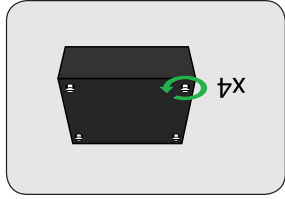

Remove the 4 screws from the battery case.

Philadelphia Scientific LLC

207 Progress Drive,
Montgomeryville, PA 18936 USA

P: 215.616.0390 F: 215.616.0500

Web: www.phisci.com

PAKA554
06/2012



HEALTH AND SAFETY PRECAUTIONS
Batteries contain sulphuric acid, always wear approved protective clothing (gloves, goggles and apron).



Installation

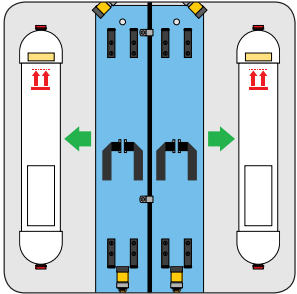

1-Remove cartridges from the packaging included with the unit.

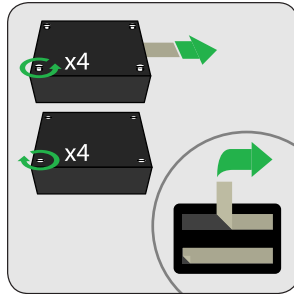

3-Loosen screws of the battery case and pull out tape to activate. Re-tighten screws and remove backing tape from the velcro strips

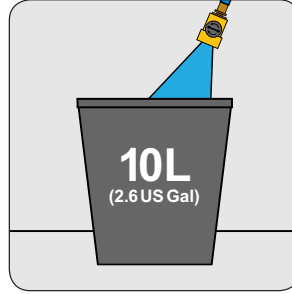

5-Turn Handle from the "OFF" position to the "LEFT" position to open the water flow to the cartridge. Pass 10 Liters (2.6 US Gallons) of water through the system into a bucket.

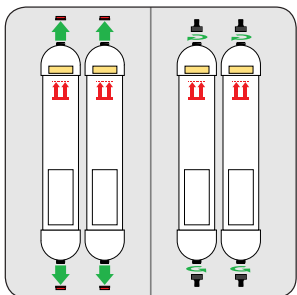

2-Attach both cartridges to the mounting plate using the straps. Ensure arrows are pointing up.

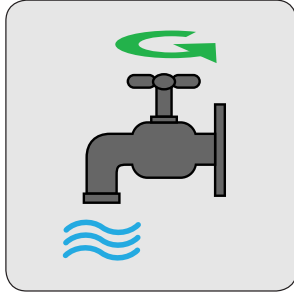

4-Turn on water supply.

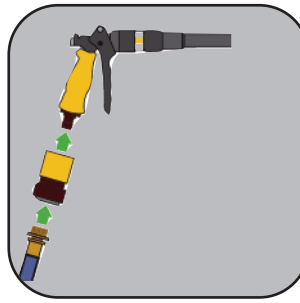

6-Attach Watering Gun to the free end of the blue hose.

Normal Operation

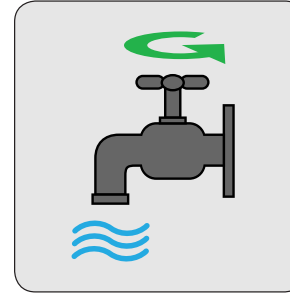

Turn on the mains water supply before use.

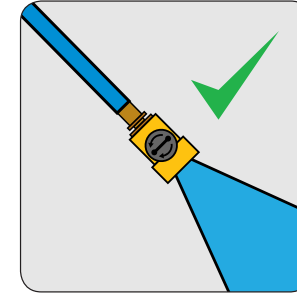

Ensure water is flowing through the system and use as required.

Cartridge Selection

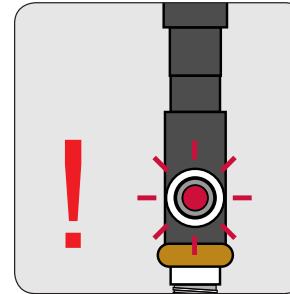

If the Purity Light flashes red then the cartridge needs replacing. Rotate the Selector Valve to the other cartridge.

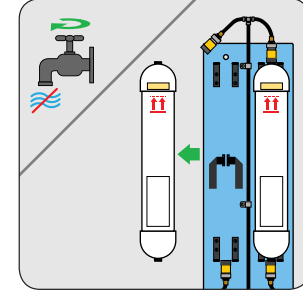

Replace the spent cartridge as shown and dispose of properly.