



Philadelphia Scientific®
industrial battery innovation

Stealth Watering System™

(Barbed Fitting)

Installation & Operation



What does a Stealth Watering System™ Kit include?

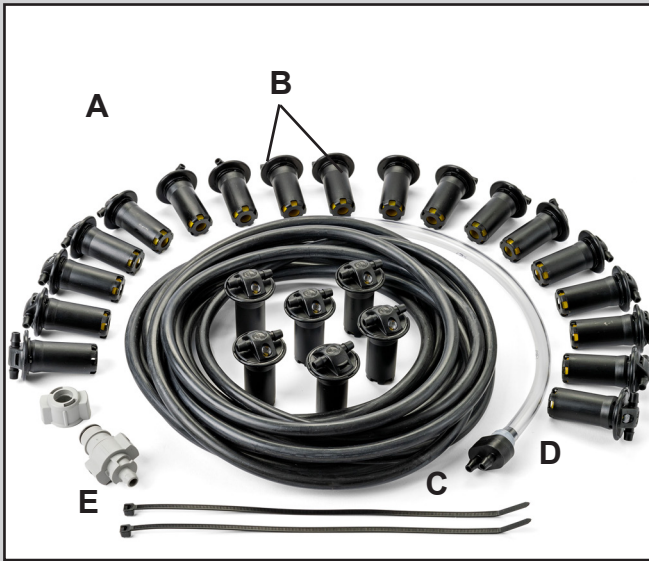

- This pack contains:
- # x Stealth valves (A)
 - 2 x End Plugs (B)
 - 1 x Coil of Tubing (C)
 - 1 x Input Assembly (D)
 - 1 x Quick Connect Coupling (E)

18 Cell Stealth Watering System™ Kit
for 36 Volt Batteries

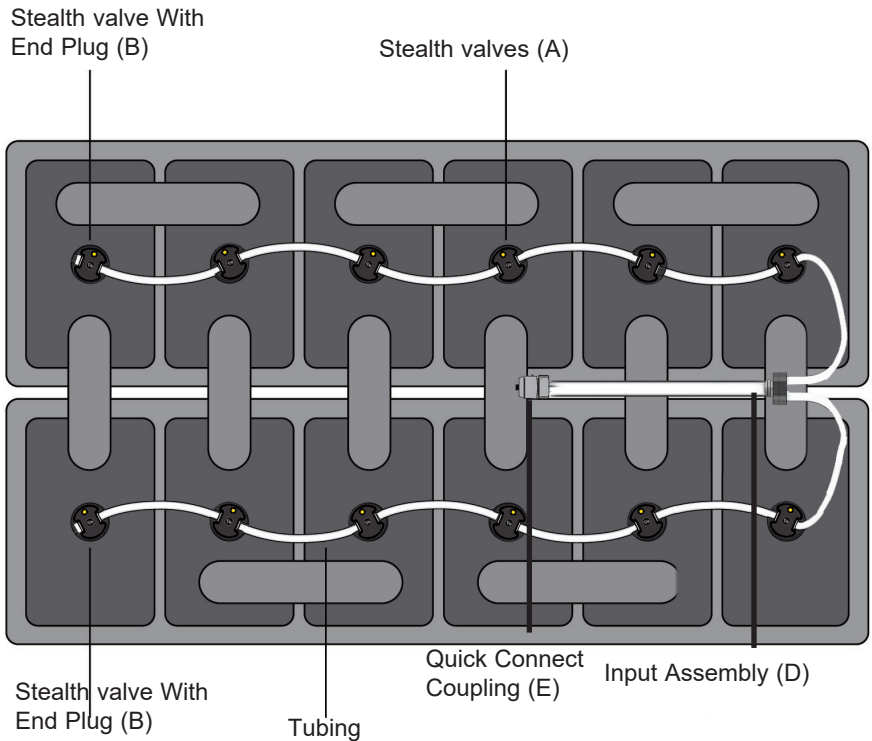

Installation:

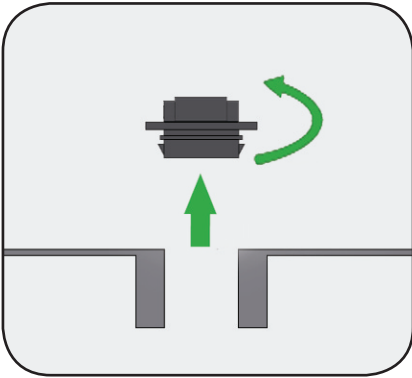

Remove the vent caps from each battery cell.

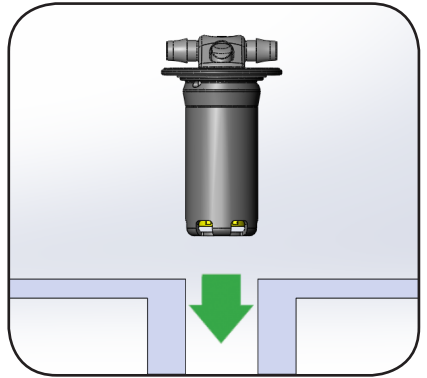

Place a Stealth valve into the vent hole of each battery cell and press firmly into place.

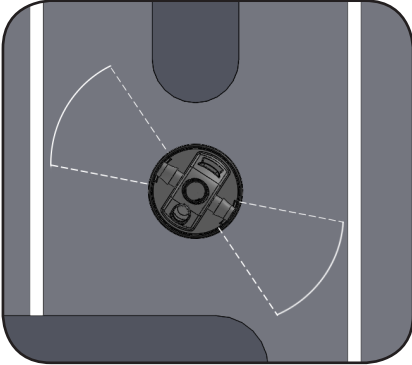

Ensure there is clear access to both of the valve's tubing barb.

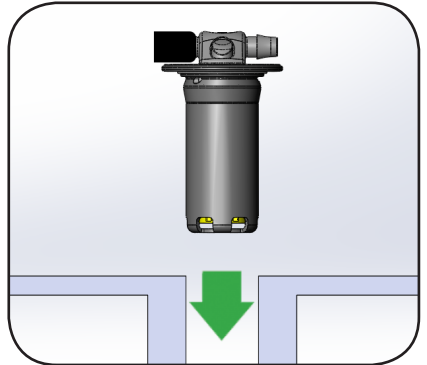

Locate the Stealth valves with end plugs where the system will terminate.

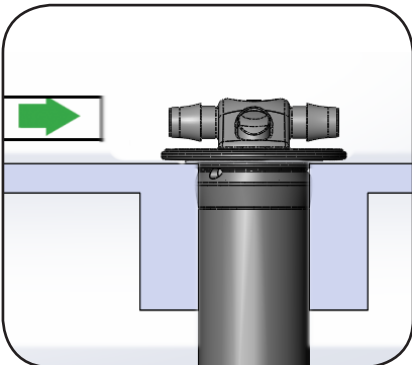

Fully insert the free end of the Tubing onto the first valve's barb and push firmly until it stops.

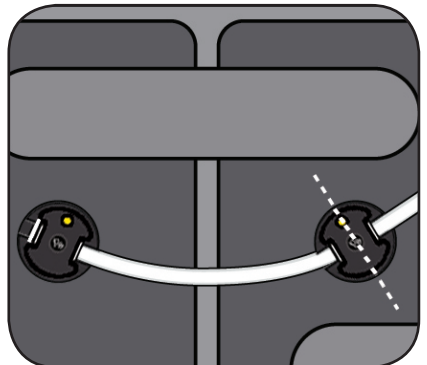

Measure the tubing to the middle of next valve in the sequence, ensuring a small amount of slack.

Installation (continued):

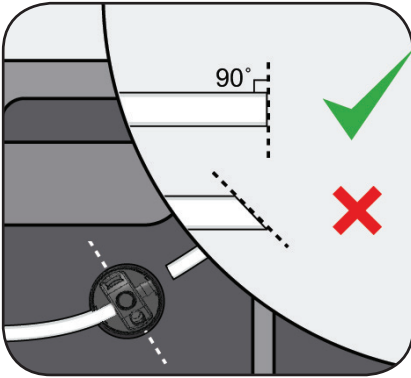

Cut the tubing squarely at this point using a tubing cutter ensuring end of tubing is not crushed.

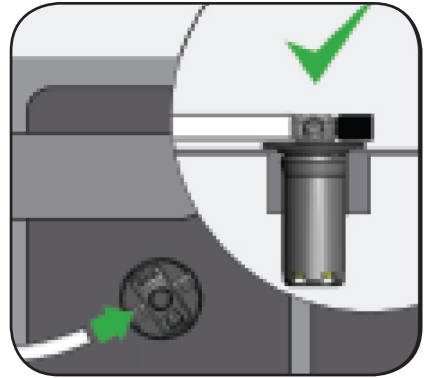

Insert the cut end of the tube on to the second valve and press firmly.

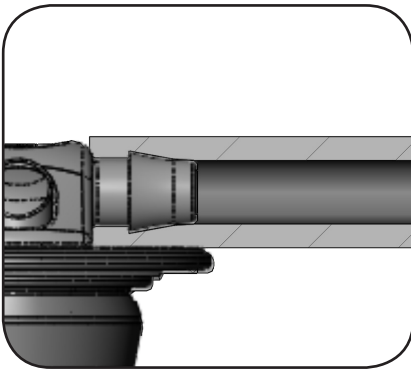

The PVC tubing must be cut squarely and fully inserted on to each valve or it will leak.

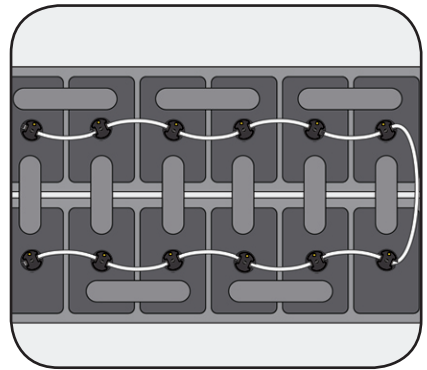

With the remaining tubing securely connect all of the valves together in the same way.

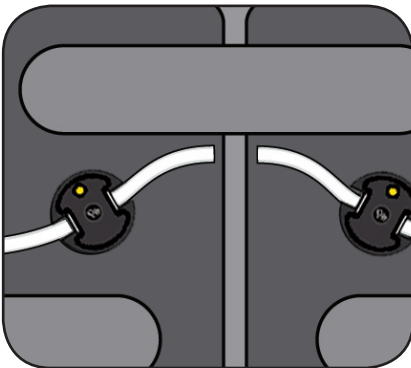

Once the tubing is fitted, choose a suitable position for the Water Input Assembly & cut the tubing.

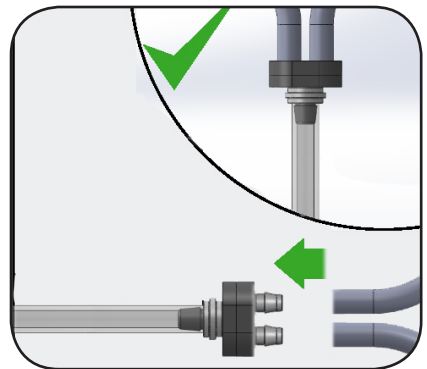

Fix the Water Input Assembly by firmly inserting the tube in the same way as with the valves.

Installation (continued):

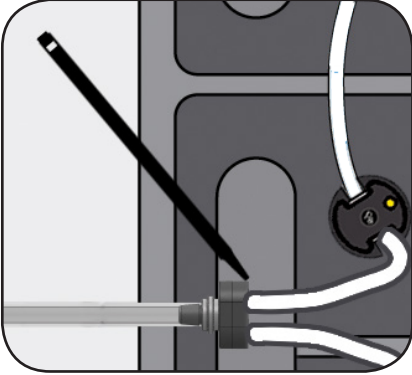

Secure the Input assembly to an inter-cell connector.

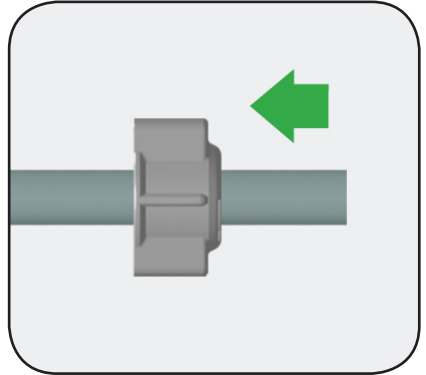

Slide the twist lock ring onto the free end of the Water Input Assembly.

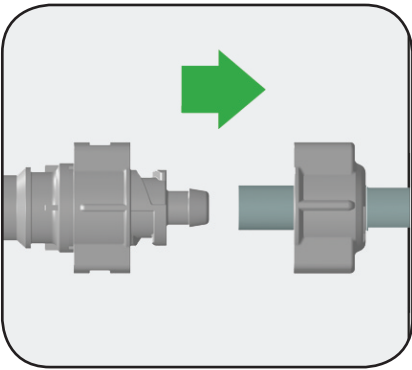

Insert the barb fitting of male quick connect fitting into the tubing.

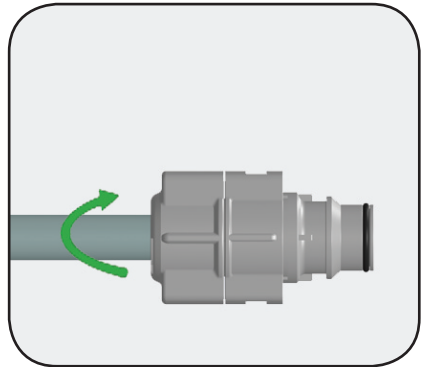

Push twist-lock ring and quick connect together & twist to lock onto the tubing.

Sample 12-Cell Layout

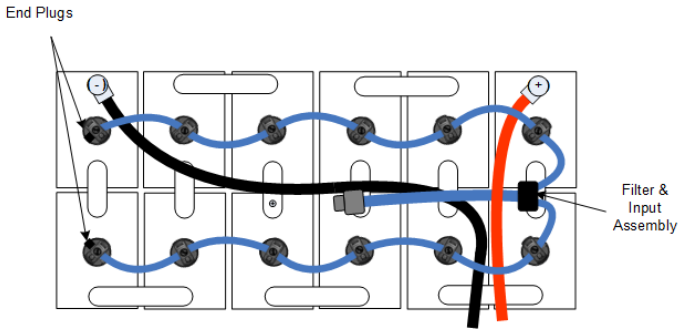

Sample 18-Cell Layout

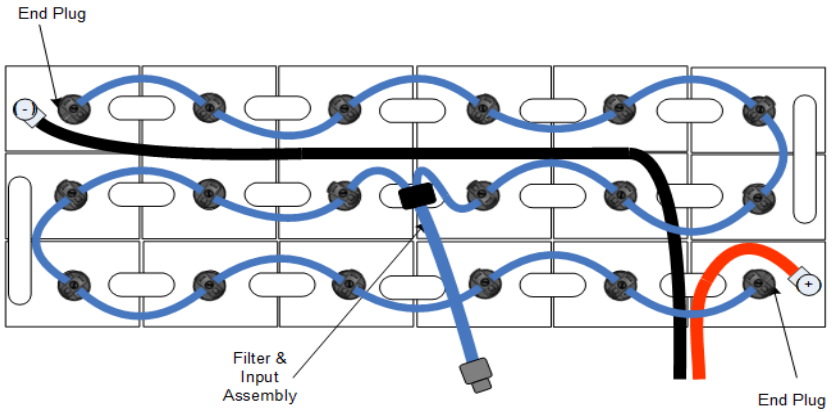

Sample 24-Cell Layout

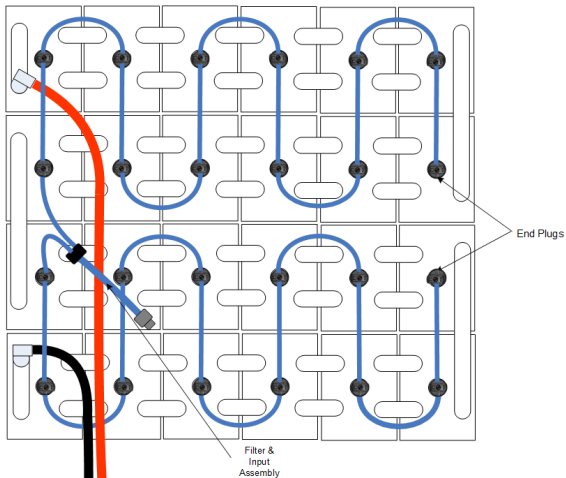

Operation:

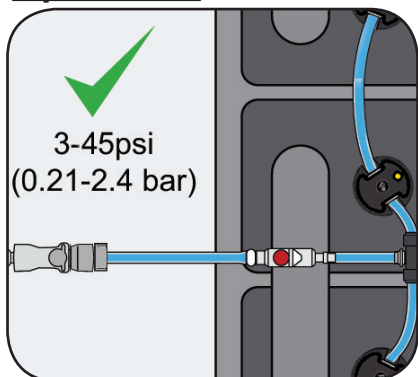

Working pressure is between 3-45psi (0.21-2.4 bar).

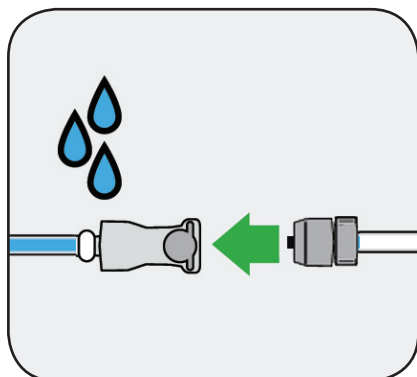

Connect the quick-connect fitting to a suitable water supply.

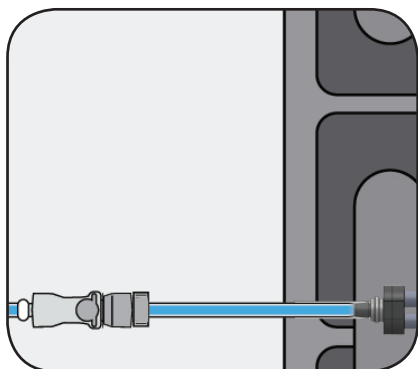

Filling will begin as soon as the connection is made (filling method dependent).

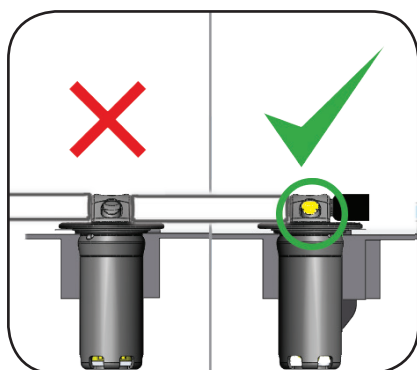

When all of the valves' fill level indicators are up the spinner on the Stealth water supply will stop.

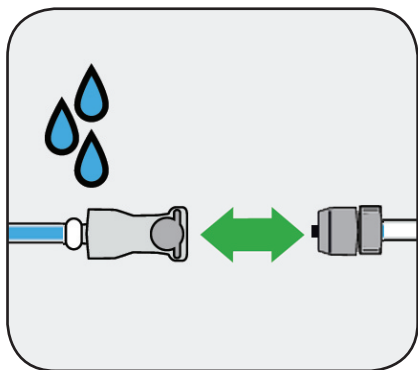

Once filling is complete disconnect the quick-connect.

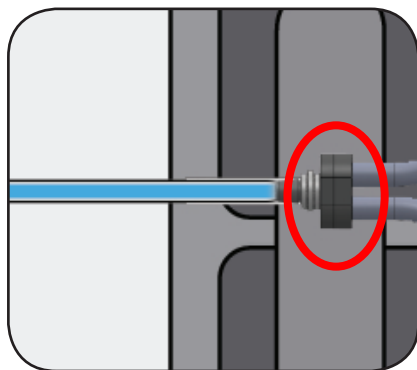

The filter traps impurities before they enter the Stealth valve and your battery. If the filter is visually clogged or fill-time become longer, change the filter. Part ID FLT-099Y

Valve Removal:

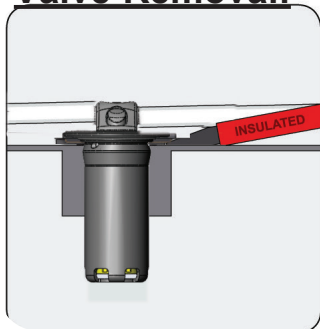

To remove a valve, insert an insulated screwdriver (or similar) under the lip of the valve.

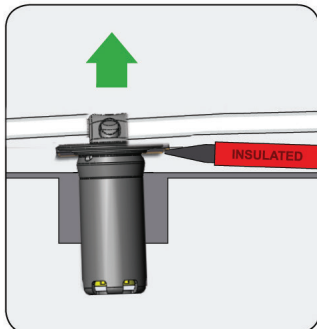

Gently pry the valve out by levering around the lip.

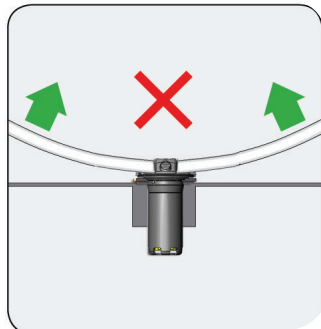

Do not try to remove the valve by pulling on the tubing.

Water Supplies

<p>DC Watering Cart (FLT-DC12)</p>	<p>Direct Link (FLT-DL)</p>	<p>Gravity Tank (FLT-GT)</p>	<p>Hydropure Deionizer (PS-300 & FLT-070 adapter required)</p>

© 2019 Philadelphia Scientific LLC. All Rights Reserved. Philadelphia Scientific and the PS logo are registered trademarks of Philadelphia Scientific. Stealth Watering System is a trademark of Philadelphia Scientific LLC. E&O.E.



Philadelphia Scientific LLC. 207 Progress Drive Montgomeryville, PA 18936
P: 215.616.0390 F: 215.616.0500 www.phlsci.com