

# AFS™

## AquaFillingSystem™

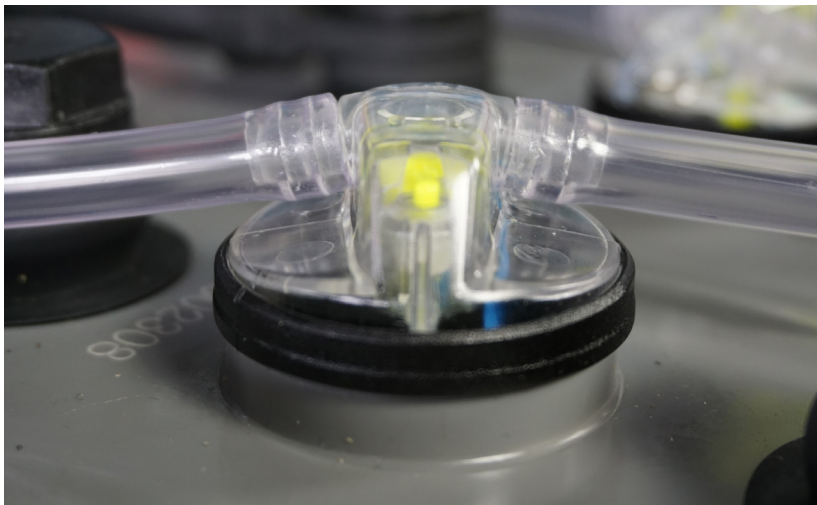

### THE UNIVERSAL BATTERY FILLING SYSTEM WITH MINIMAL PARTS AND EASY INSTALLATION.



### The lean battery filling system that does more with less.

At Philadelphia Scientific we are driven by the philosophy of 'lean' to ensure our customers use less time, money and effort to achieve more.

Our challenge when designing a new battery filling system was to use fewer components but offer more features and benefits than current market offerings, all for a lower price. Furthermore the system needed to be compatible with the methods and standards currently in use.

By taking a fresh look at how to make a float control water, and stop reliably every time, we are now proud to present the innovative Aqua Filling System (AFS).

“What we have done is completely rethink the way float systems work to build a simple, cheap and more reliable filling system.” **Duncan Jones**

Along with being faster to install and having fewer parts than the competition, the AFS offers a host of additional benefits:

- ✓ an easily accessible hydrometer hole
- ✓ maximum visibility for the level float
- ✓ a water trap
- ✓ branding
- ✓ a low profile
- ✓ the ability to integrate with common industry standards for fill heights and tube widths

In addition, our new shut off mechanism is more reliable than any other low to mid pressure range watering system that has come before it. This means battery builders can be confident they have the fastest system to install, reducing assembly costs; battery distributors can be confident they always have the correct items in stock without tying up capital and space; battery owners can be confident their batteries are being watered safely and efficiently and battery maintenance people can be confident they have done their job correctly.

## Features and benefits summary

**One float for all heights:** A single float with five settings does what other filling systems do with 19 different floats.

**One valve for all batteries:** The base AFS valve is for bayonet vents simply add an adapter for the DIN or GS.



**Easily adjustable – even in operation:** If you find the application needs higher or lower fill heights the AFS can be adjusted without changing any parts.

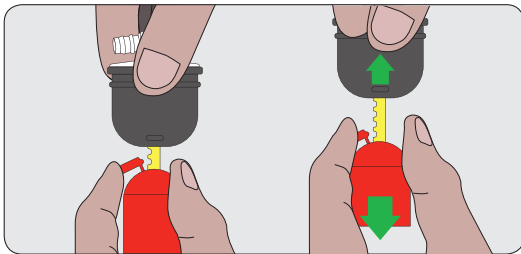

**Improved battery life:** Batteries must be watered, the AFS makes the process quicker and safer than manual watering and the low price point makes single point watering more accessible to cost conscious customers.

**High visibility water level indicator:** Instead of a white eye that is hard to see inside a dark battery compartment, the AFS has a fluorescent, magic eye that can be seen from every angle.

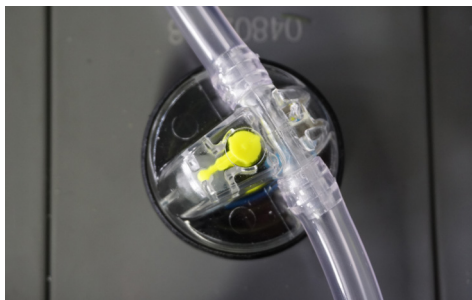

**Watch the action:** The transparent bayonet and tube enable operators to watch water enter the cell.

**Wide operating pressure:** The AFS runs at industry standard 0.2 – 3 bar, (3.8 psi to 43.5 psi).

**Compatible with battery filling systems:** The AFS can be used with standard 6mm battery filling system tubing and connections.

**Three parts:** The AFS system is made up of just three core parts: the valve, the tube and the output assembly. This saves money being tied up in inventory and reduces installation time.

**Fast install:** Select the float, put the valve in the cell and connect with the tube – no collars required!!

**Accessible hydrometer port:** Measure specific gravities without having to open a lid with the easily accessible hydrometer port.

**Engineered to be tough:** The AFS is built to withstand the harsh environment of industrial battery applications. All materials are corrosion resistant and the low profile design protects against damage from battery cables and other hazards. The AFS has been designed to last the life of the battery.

**Inexpensive and cost effective:** The AFS is inexpensive, and when combined savings from the quick installation time and the reduction in capital tied up in parts, delivers a rapid return on investment.

**Interchangeable:** The AFS can be removed from one battery and easily fitted to another and different vent types can be accommodated with the addition of an adapter.

**Satisfaction guaranteed:** The AFS is covered by a one-year conditional warranty and has an anticipated design life of greater than five years.

## Specifications

Input/Operating Pressure	0.2 – 3 bar/3.8 to 43.5psi
Acceptable Battery Filling Temperature	2°C to 71°C
Acceptable Exposure/ Application Temperature	-29°C to 71°C
Max Valve Height Above Vent Opening	2.2 cm
Valve Body Material	Polypropylene
Tubing Material	Proprietary Flexible PVC
Tubing Diameter	6mm
Fitting	US/DIN/BS/GS



**Philadelphia Scientific**  
industrial battery innovation

[www.phlsci.com](http://www.phlsci.com)

### Philadelphia Scientific Americas

207 Progress Drive, Montgomeryville, PA, 18936 USA  
P: +1 (0) 215 616 0390 F: +1 (0) 215 616 0500

### Philadelphia Scientific EMEA

188 Oxford Grove, Bolton, BL1 3BH, UK  
P: +44 (0) 1204 467777 F: +44 (0) 1204 493300

### Philadelphia Scientific Asia Pacific

2/17 Norman Street, Peakhurst, NSW, 2210, Australia  
P: +61 (0) 2 8004 2447 F: +61 (0) 2 9012 0383