

OPTION: Place AFS cap over the barbs.

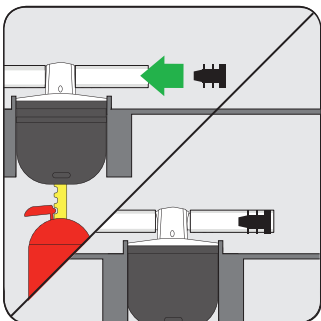

OPTION: Place End Plug in the tubing.

Operation

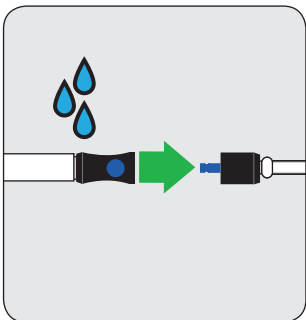

Connect to a suitable water supply.

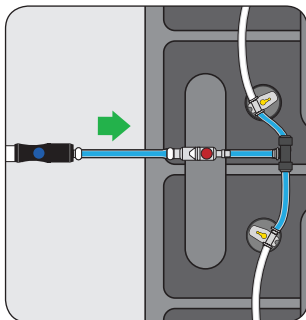

The water stops automatically. Disconnect the water supply.

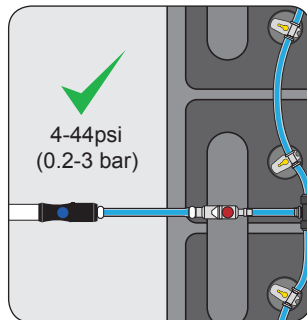

Working pressure is between 4-44psi (0.2-3 bar).

AFS Removal

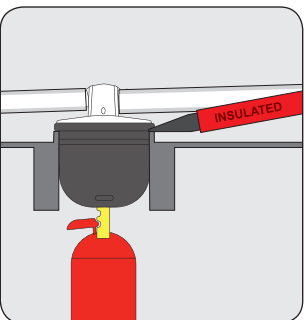

Remove by inserting an insulated screwdriver (or similar) under the lip of the AFS.

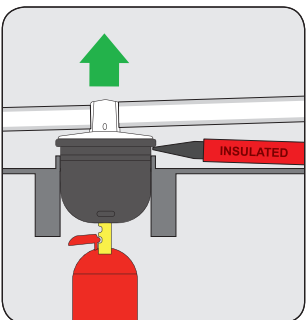

Gently pry the AFS out by levering around the lip.

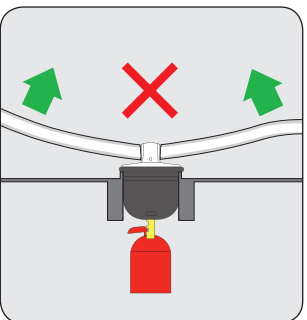

Do not try to remove the AFS by pulling on the tubing.

Aqua Filling System™ (AFS)

Universal Battery Watering System



Installation Instructions

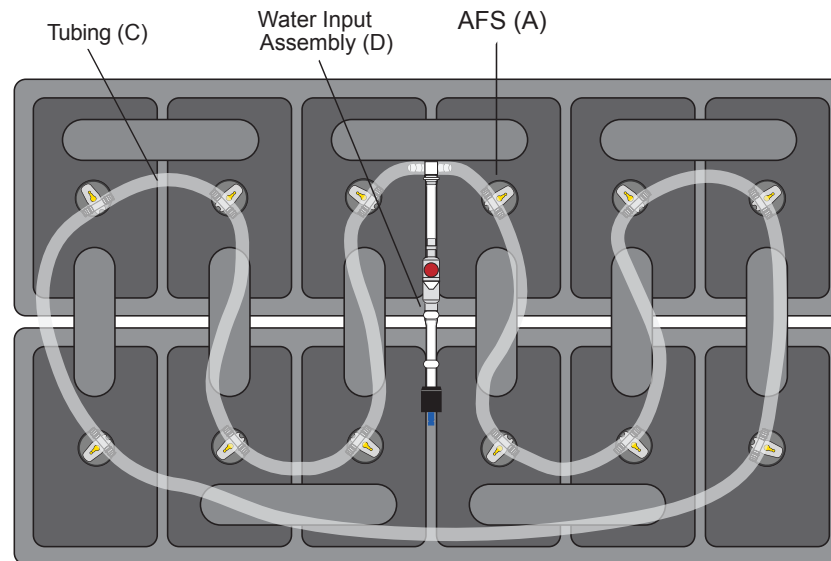

Required:

- 1) # x AFS (A)
- 2) 1 x Coil of PVC Tubing (C)
- 3) 1 x Water Input Assembly (D)

Optional:



4) 2 x End Plugs (B)

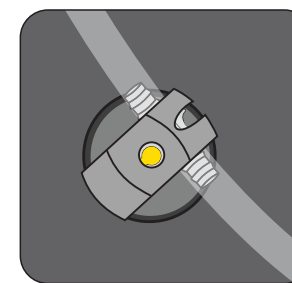

5) # x AFS Caps (E)

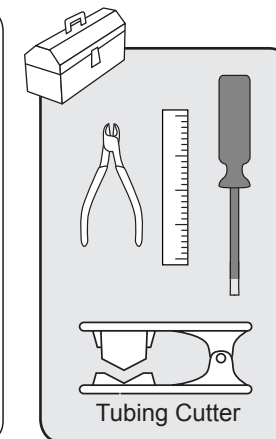

Copyright © 2015 by Philadelphia Scientific LLC. All Rights Reserved. Philadelphia Scientific and the PS logo are registered trademarks of Philadelphia Scientific LLC. Aqua Filling System is a trademark of Philadelphia Scientific LLC.

Americas: Info@phlsci.com EMEA: info@ps-europe.net Asia Pacific: info@phlsci.com.au www.phlsci.com



HEALTH AND SAFETY PRECAUTIONS
Batteries contain sulphuric acid, always wear approved protective clothing (gloves, goggles and apron).



Installation

AFS-VD1 and AFS-VQ1			
T1	T2		
Distance measured from the top of the vent to			
Bottom of the float when fully extended (x) in mm	Liquid level at shut off in mm	AFS float position	Industry standard float size
47	36	1	20
52	40	2	24
57	45	3	29
62	50	4	34/39
67	54	5	44

AFS-VA1			
T1	T2		
Distance measured from the top of the vent to			
Bottom of the float when fully extended (x) in mm	Liquid level at shut off in mm	AFS float position	Industry standard float size
45	34	1	20
50	38	2	20
55	43	3	29
60	48	4	34
65	52	5	39/44

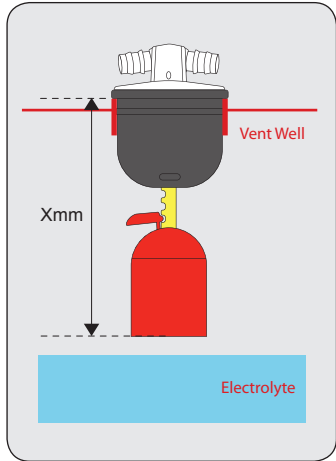

Check manufacturers guidelines for fill heights. If there are no guidelines available then always use the longest setting possible, ensuring there is a 5mm gap from the top of the separators to the underneath of the float in the extended position.

All fill heights are measured from the underside of the AFS cap (top of the vent well).

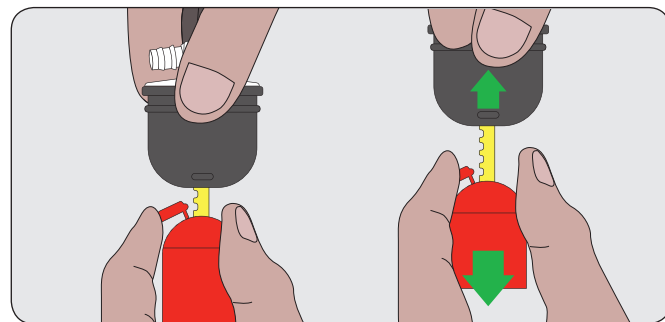

Pull the pin back and then move the float to the required position.

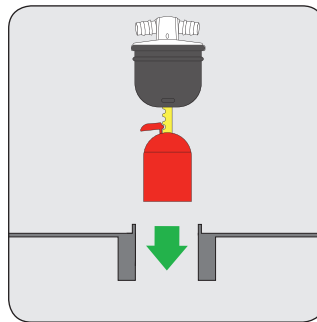

Place an AFS into the vent hole of each battery cell and press firmly into place.

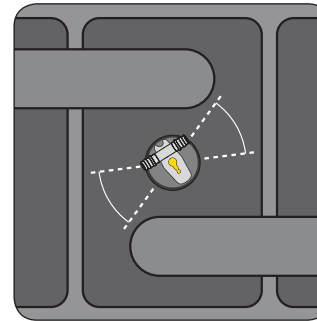

Ensure there is clear access to the AFS tubing ports.

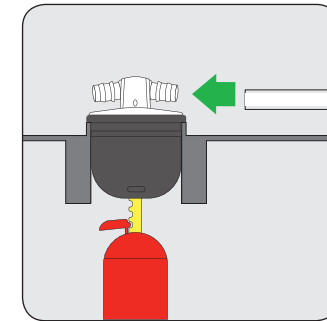

Fully push the free end of the tubing on to the first AFS and push until it stops.

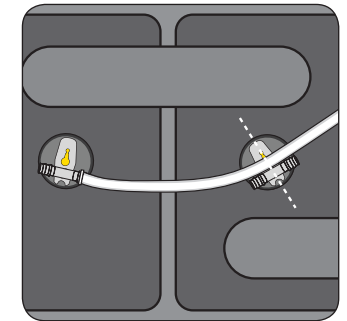

Measure the tubing to the middle of the tubing on to the first AFS and push until it stops.

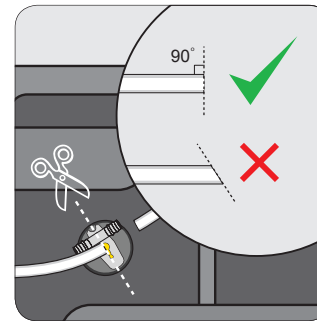

Cut the tubing square at this point using a tube cutter or scissors ensuring end of tubing is not crushed.

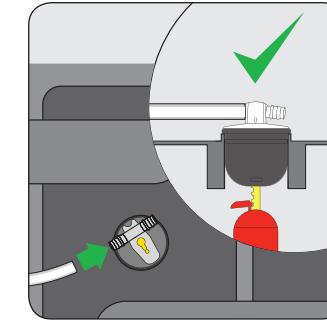

Push the cut end of the tube in to the second AFS and press firmly.

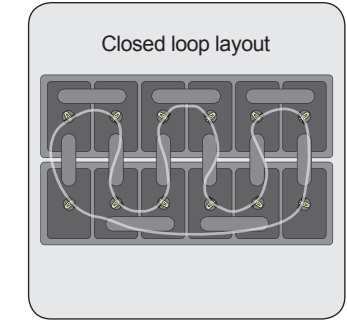

With the remaining tubing securely connect all of the AFS together in the same way.

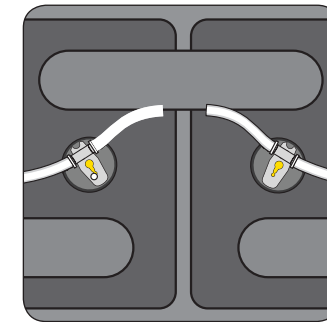
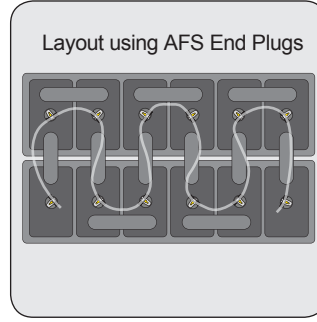

Once the tubing is fitted choose a suitable position for the Input Assembly and cut the tubing.

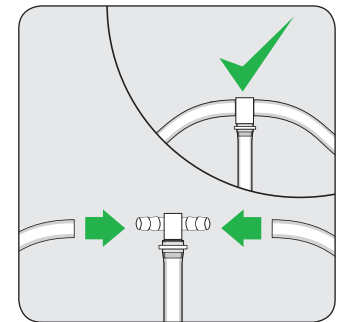

Fix the Water Input Assembly by firmly inserting the tube in the same way as with the AFS.